

wall mount kit

for
bathroom cabinet

SIDLER Singla



Please read instructions before proceeding

Save these instructions





IMPORTANT SAFETY INSTRUCTIONS – to reduce the risk of burns, fire, electric shock, or injury:

- **This product is for household use only**
- **WARNING – do not use outdoors**
- **WARNING – use this furnishing only for its intended use as described in these instructions**
- **WARNING – never operate the furnishing with the air openings blocked. Keep the air openings free of lint, hair, and the like**
- **WARNING – never drop or insert any object into any opening**
- **WARNING – avoid dispensing of aerosol sprays near top of the cabinet**

- **SAVE THESE INSTRUCTIONS**

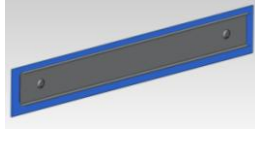
List of all components to be installed

Pos.	Pcs.	Description	Dimension [mm]	Comment
1	2	side mirror		wall mount only
2	4	screw	4.5x35	Singla mount kit
3	4	raw plug	Ø 10mm (0.4")	wall mount only
4	4	screw	M4x6	wall mount only

			
pos. 1 Side mirror	pos. 2 Screw	pos. 3 Raw plug	pos. 4 Screw

Installation Guide

Step 1 – Assembly Rail

- 1) Place the cabinet at the desired height (positioning the bottom edge of the cabinet at 47.25" (120cm); recommended assembly height).

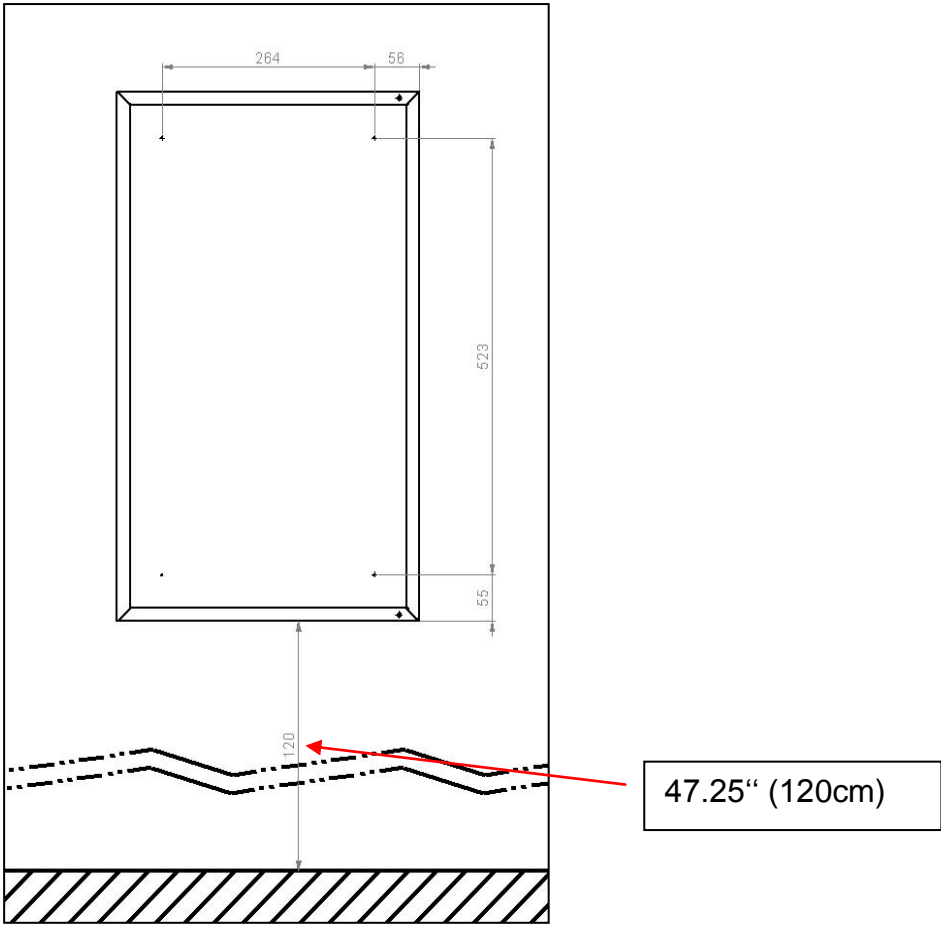

- 2) Align the cabinet and check using a spirit-level.
- 3) Mark the drilling point on the wall using the drill-holes in the rear wall of the cabinet.

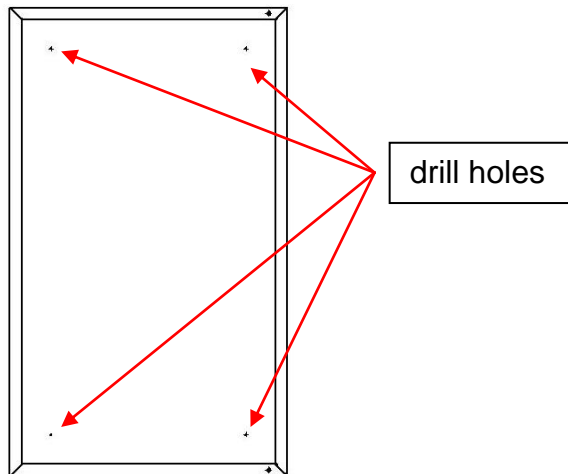

- 4) Drill the holes $\text{Ø}10\text{mm}$ (0.4") deep into the wall.
- 5) Place the raw plugs (pos. 3) into the drilled holes.

Step 2 – assembling side mirrors

- 1) Place side mirror carefully at provided position

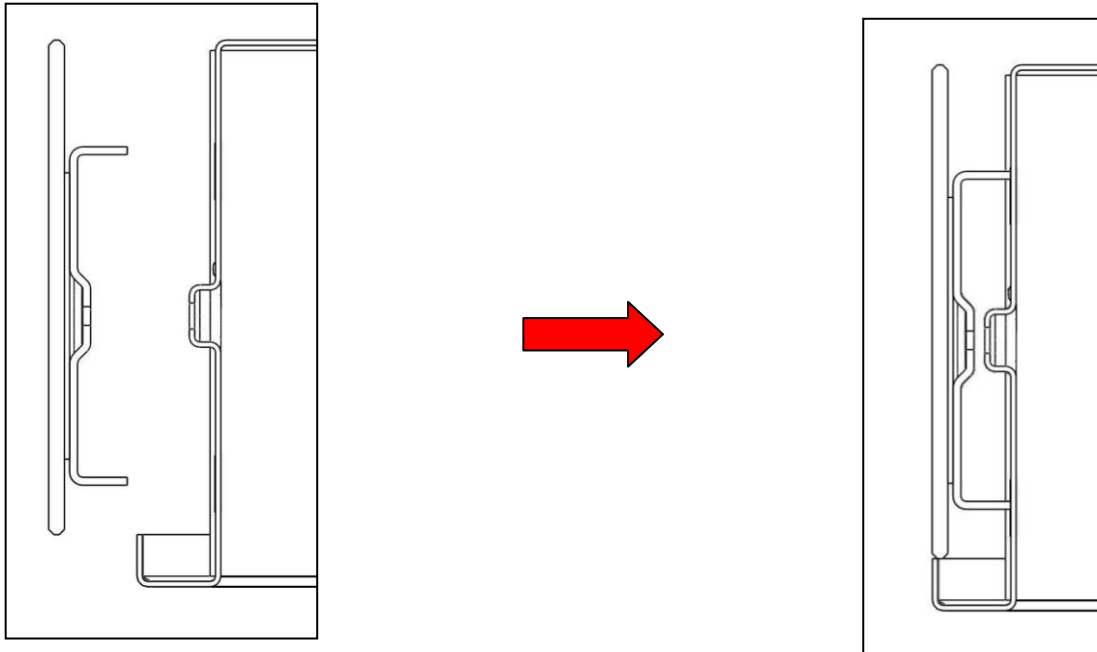

- 2) Lock side mirror in place by carefully screw

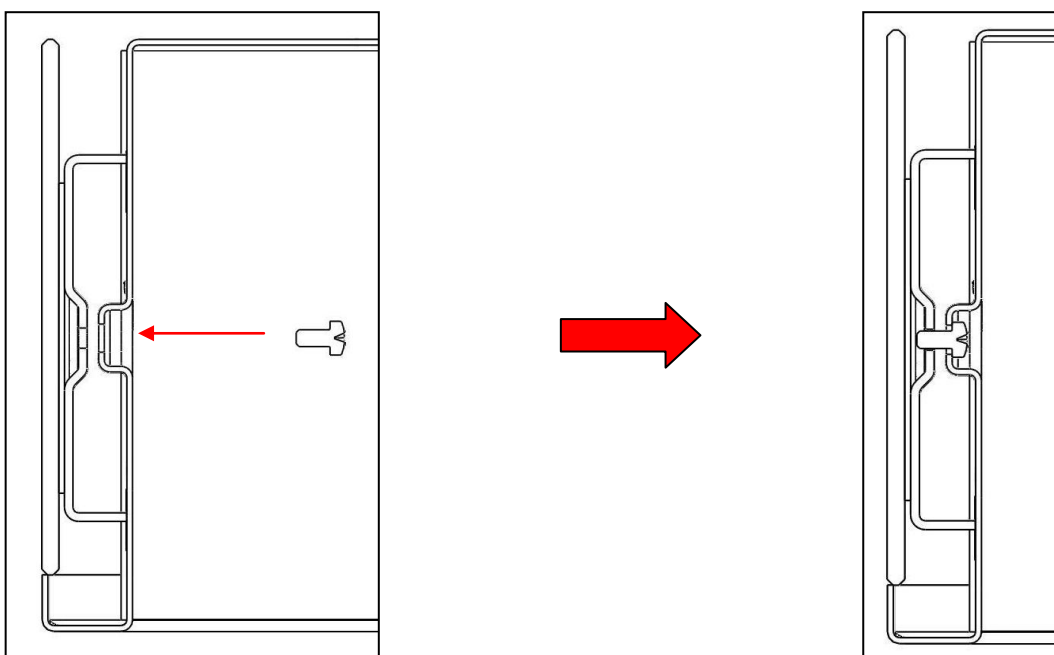

Step 3 – Mount the Cabinet

- 1) Position the mirror cabinet in the desired position and check that it is level using a spirit-level
- 2) Screw the cabinet to the wall via the mounting holes
- 3) Tighten the screws (pos. 2)

=> proceed with

OPERATION INSTRUCTIONS *Singla* Step 5 (Doors)

LIMITED WARRANTY

SIDLER will provide a two-year warranty in respect of defects associated with the Product, commencing from the date of delivery, subject to the following conditions:

- (I) The Product must have been professionally mounted and installed by a certified licensed contractor in accordance with the *Safety Standards Act*, S.B.C. 2003, c. 39, as amended, and the Electrical Safety Regulation B.C. Reg. 100/2004, as amended.
- (II) The Product must have been used by the Purchaser in the manner and for the purpose recommended and authorized by SIDLER and the manufacturer.
- (III) The Product must not have been modified, or changed in design or function following delivery.
- (IV) In each case, written notice by the Purchaser specifying the alleged defects must be received during the warranty period (within two years of the date of delivery).
- (V) The warranty is limited to replacement parts only.
- (VI) Damages resulting from normal wear and tear are excluded. The determination of whether damage has so resulted will be in the sole discretion of SIDLER.
- (VII) Damages resulting from any errors in representations made by the manufacturer regarding product specifications are excluded.

SIDLER International Ltd.

#205 – 2999 Underhill
Avenue
Burnaby, BC V5A 3C2

Phone: (604) 415 24 22
Toll Free: (888) 415 24 22
Fax: (604) 415 24 33
E-mail: info@sidler-international.com
Homepage: www.sidler-international.com